

# ENR-110

## 4-Channel Desktop Standalone NVR



- 2-bay Desktop
- Manage up to 4 cameras or video encoders
- Recording up to 4 Channels
- Live view local up to 4 Channels, remote up to 4 Channels
- Synchronized playback local up to 4 Channels
- Export video with RAW and AVI formats
- Event trigger, response and notification
- Mobile Client, Web Client
- 4-channel free license included

### PHOTO INDICATION

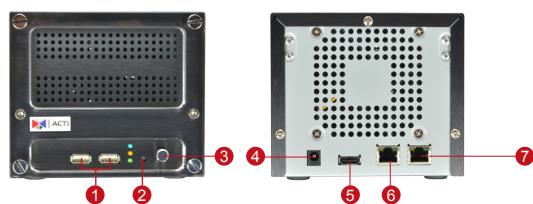

- |                      |             |
|----------------------|-------------|
| 1 USB 2.0 Ports      | 5 HDMI Port |
| 2 Reset Button       | 6 LAN1      |
| 3 Power Button       | 7 LAN2      |
| 4 DC 12V Power Input |             |

### DIMENSION DIAGRAM

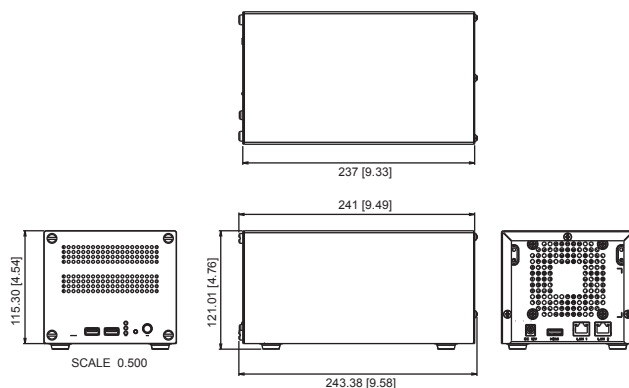

Unit: mm [inch]

### SOLUTION ARCHITECTURE

#### Standalone NVR

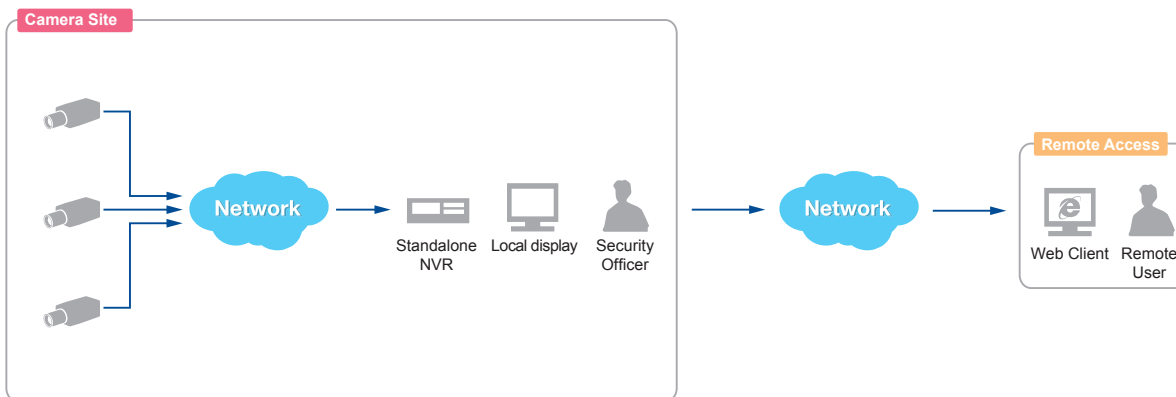

Remote User: Administrator / Supervisor / Manager / Security Officer

**PRODUCT SPECIFICATION****ENR-110****• General**

Full Name	ACTi Standalone Network Video Recorder ENR-110
Maximum Number of Clients	1 local, 2 remote
Maximum Number of Cameras	4
Video Compression	H.264
Audio Compression	PCM, G.711 a-law/u-law (Only support local recording and remote live view/playback, not support local live view/playback)
Maximum Camera Resolution	Up to 4-Megapixel (local display), Up to 10-Megapixel (remote display)

**• Live View**

Display Layout Mode	1, 2, 4
Layout Tour (Auto Patrol)	Automatic switch between different display layouts
Digital Zoom	Zoom in digitally by mouse
Event Status	Display status for network/record/motion/DI/video loss upon every video region
Dual Stream Management	Live view of stream 1 or stream 2 of dual stream devices

**• PTZ**

Control	Pan, tilt and zoom controls; speed control
Preset Points and Tours	Go/set preset points
Number of Preset Points	32
Joystick	USB based joystick supported
Default Protocol	URL command

**• Recording**

Scheduled Recording	Record video with user defined schedule
Event Recording	Record video when the alarm event is triggered, including the pre-event buffered video clip
Event Speed-up Recording	Record 1 frame only in normal status, and record full frames when the alarm event is triggered
Manual Recording	Instant recording upon mouse click
Recording Frame Rate	Max 120 fps in total; Max 30 fps per camera
Maximum Recording Throughput	16 Mbps
Dual Stream Management	Recording of stream 1 or stream 2 of dual stream devices

**• Storage**

Interface	Serial ATA
Maximum HDD Capacity	4T x 2
HDD Bay	Maximum 2 disks Maximum 2 disks (options to have empty bays or one 1TB storage disk included)

**• Search & Playback**

Time Based Video Search	Search video recordings by time, channel or bookmark
Event Based Video Search	Search event triggered video recordings, event response video loss
Playback Control	Forward and backward playback with speeds 1/2x-1x-32x; pause; stop
Synchronized Playback	4 channels
Manual Snapshot	Create snapshot from playback for export
Video Cropping	Crop a short video clip from long recording file and save it as an independent file; video clip length:(1-30mins)
Video Export	Export video clips in AVI/RAW format

**• Event Management**

Event Trigger	Video motion detection; External device through digital input; Network loss and recovery
Event Response	Record video; Play alert beep; Activate external device through camera digital output; E-mail notification with snapshots; Enlarge; video loss; Go to PTZ preset point

**• System**

Permission Control	Multi-group/users, liveview/playback/setup/remote level permission
Operating System	Embedded Linux
System Status Monitor	Real time status reports on remote browser
Language	Multi-language support

**• Remote Access**

PC Web Browser	Microsoft Internet Explorer 9, 10 or 11
Remote Client PC System Requirement	Intel Core 2 Quad 2.66 GHz, 32/64-bit, 4GB RAM
Mobile Client Program	Mobile device application (ACTi Mobile Client) supports live view, PTZ control, event or time based search and playback Supported devices: iPhone, iPad, iTouch and Android device

**• Hardware**

Dimensions (W x H x D)	135 mm x 121 mm x 251 mm ( 5.3" x 4.8" x 9.9")
Weight	1.32 kg
Operating Temperature	0°C~ 40°C (32°F ~ 104°F)
Operating Humidity	10% ~ 85% RH
Power Source / Consumption	DC 12V/ 22W
Bundled Accessories	Warranty Card / QIG / Power Adapter (100~240V) / Mouse / Universal Converter/HDD screw x 8
Approvals	ENR-110: CE (EN 55022 Class B, EN 55024), FCC (Part15 Subpart B Class B); Adapter: CE, FCC, UL, PSE, Efficiency Level V
USB	USB 2.0, 2 ports (USB 1.1 not supported)
Ethernet Port	LAN1: 1000Base-T ; LAN2: 10/100Base-T (WAN port)
Display Port	HDMI

**• Integration**

Unified Solution	Fully compatible with ACTi cameras, encoders and CMS V2.0
Open Platform Solution	Support ONVIF compliant devices

\* All specifications are subject to change without notice.

\* All brand names and registered trademarks are the property of their respective owners.

[www.acti.com](http://www.acti.com)