

# A87

5MP Outdoor Zoom Dome with D/N, Adaptive IR,  
Advanced WDR, SLLS, 4.3x Zoom Lens



- 5 Megapixel
- Day & Night with Superior Low Light Sensitivity and Adaptive IR LED
- 4.3x Zoom Lens with f2.8~12mm / F1.4~2.8, DC-Iris, Auto Focus (for installation)
- Advanced WDR (120 dB)
- 30 fps at 2592 x 1944
- Weatherproof (IP66) and Vandal Proof (IK10)

## PHOTO INDICATION

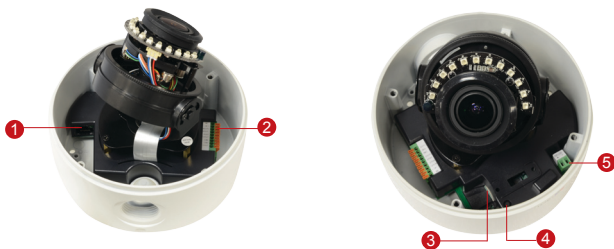

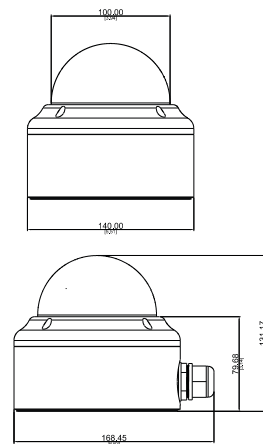

- |                          |                      |
|--------------------------|----------------------|
| ① Ethernet Port          | ④ Reset Button       |
| ② Digital Input / Output | ⑤ DC 12V Power Input |
| ③ Memory Card Slot       |                      |

## DIMENSION DIAGRAM



Unit: mm [inch]

## ACCESSORY OPTIONS

Power Supply		
PPOE-0001		PoE Injector, IEEE 802.3af compliant, AC 100~240V, with universal connectors
PPBX-0011		Power Adapter AC 100~240V, with universal connectors for all DC 12V powered devices

Popular Mounting Solutions	
Surface	Accessories not required
Wall	PMAX-0321 
Pendant	PMAX-0113 

\* For more mounting solutions, please refer to the Mounting Accessory Selector on [www.acti.com/mountingselector/](http://www.acti.com/mountingselector/)

## PRODUCT SPECIFICATION

### • Device

Device Type	Outdoor Zoom Dome Camera
Image Sensor	Progressive Scan CMOS
Sensor Size	1/2.9"
Effective Pixels	3096 (H) x 2202 (V) (6.82 MP)
Horizontal Resolution	1300 TVL
Day / Night	Yes
Low Light Sensitivity	Superior
Mechanical IR Cut Filter	Yes
IR Sensitivity Range	700 - 1150nm
IR LED	Adaptive IR LED x 12 (850nm)
IR Working Distance	30 m
Horizontal Resolution (TV Lines)	1300 TVL
S/N Ratio	56 dB

### • Lens

Focal Length / Aperture	Zoom, f2.8 ~ 12mm / F1.4 ~ 2.8
Zoom Ratio / Speed	4.3x optical
Zoom Application	Camera Installation
Iris	DC-iris
Focus	Auto focus
Lens Mount	Board mount
Horizontal Viewing Angle	71° ~ 25°
Viewing Angle Adjustment	Pan: -135°~135° Tilt: 0°~90° Rotation: -90°~90°

### • Video

Compression	H.265, H.264 (Baseline/ Main/ High profile), MJPEG
Max. Frame Rate vs. Resolution	30 fps at 2592 x 1944 30 fps at 1920 x 1080 30 fps at 1280 x 960 30 fps at 1280 x 720 30 fps at 800 x 600 30 fps at 640 x 480 30 fps at 320 x 240
Multi-Streaming	Simultaneous triple streams based on three configurations
Bit Rate	128 Kbps ~ 20 Mbps (per stream)
Bit Rate Mode	Constant, Variable
Wide Dynamic Range	Advanced WDR (120 dB)
Digital Noise Reduction	2D + 3D DNR
Image Enhancement	White balance Brightness Contrast Sharpness Automatic Gain Control Flickerless Digital Image Stabilizer Defogging
Privacy Mask	Yes
Text Overlay	Yes
Built-in Analytics	Tampering Detection
Image Orientation	Mirror, Flip, Rotation

### • Audio

Compression	8kHz, Mono, G.711
Audio-In	Mic in, Line in, Terminal block
Audio-Out	Line out, Terminal block

### • Network

Protocol & Service	IPv4, IPv6, TCP, UDP, HTTP, HTTPS, SMTP, FTP, NTP, DNS, DDNS, DHCP, ARP, Bonjour, UPnP, RTSP, RTP, RTCP, IGMP, PPPoE, ICMP, SNMP, QoS
Ethernet Port	1, Ethernet (10/100 Base-T), RJ-45 connector
Security	IP address filtering; HTTPs encryption; Password protected user levels; Anonymous login

### • Alarm

Alarm Trigger	Video Motion Detection (3 regions) External Device through Digital Input Sound Detection Intelligent Event Detection
Alarm Response	Notify control center, Change camera settings, Command other devices, E-mail notification with snapshots, Push notification to mobile device, Save video to local storage, Upload video or snapshot to FTP server, Upload video to NVR server, Activate external device through digital output

### • Interface

Digital Input	1, Terminal block
Digital Output	1, Terminal block
Local Storage	MicroSDHC/SDXC memory card slot (card not included)

### • General

Power Source	PoE Class 3 (IEEE802.3af), DC12V
Power Consumption	12.95 W (PoE)
Dimensions (Ø x H)	139.95 x 131.17 mm (5.5" x 5.2")
Environmental Casing	Weatherproof (IP66) Vandal proof (IK10)
Mount Type	Surface, Pendant, Wall, Pole Mount, Corner, Gang Box
Starting Temperature	-20°C ~ 50°C (-4°F ~ 122°F)
Operating Temperature	-40°C ~ 50°C (-40°F ~ 122°F)
Operating Humidity	20% ~ 80% RH
Approvals	CE, FCC, IP66, IK10, NEMA 4X

### • Integration

Unified Solution	Fully compatible with ACTi software
ISV Integration	Software Development Kit (SDK) available; ONVIF compliant
GPS Position	Manual setting
Firmware Access Browser	Microsoft Internet Explorer 11